

Operation and Installation Manual

No Touch Door Release Exit Sensor ACA-NTEB

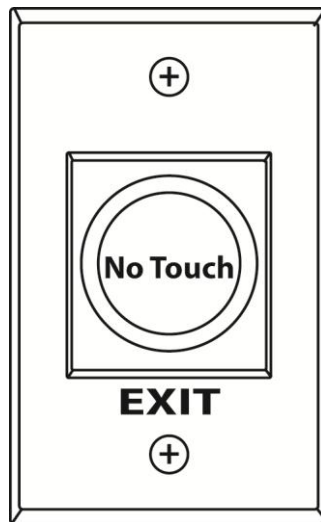

FEATURES

- No touch / Touch free Exit Sensor (Diffused Detection)
Optical / Infrared Technology
- IP55 Ingress Protection / SUS 304 Stainless steel plate
- User friendly (Healthy protection): Free from contagious diseases spread
- Detection range: 0.1 ~ 10 cm
- High capacity of relay dry contact (3A/120V AC, 30V DC)
- Normally open / Normally close / Common relay output
- Twin LED indicators for sensor standby or approached
 - Sensor Standby: Blue LED on
 - Visitors approaching within 10cm: Red LED on



Please read this installation and quick setup guide completely and keep it for your future reference.

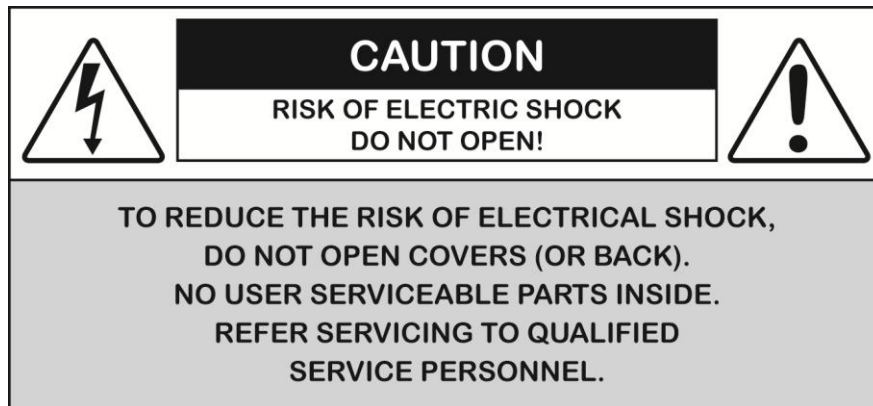

Disposal of Old Electrical & Electronic Equipment (Applicable in the European Union and other European countries with separate collection systems).

This symbol on the product or on its packaging indicates that this product shall not be treated as household waste. Instead it shall be handed over to the applicable collection point for the recycling of electrical and electronic equipment. By ensuring this product is disposed of correctly, you will help prevent potential negative consequences for the environment and human health, which could otherwise be caused by inappropriate waste handling of this product. The recycling of materials will help to conserve natural resources. For more detailed information about recycling of this product, please contact your local city office, your household waste disposal service or the shop where you purchased the product.

CAUTION

1. Handle this product with care

Avoid any shock or bumping of the product. Improper handling could damage the product. Do not operate with wet hands.

2. Cleaning

Do not use liquid cleaners or aerosol cleaners. Use a damp cloth for cleaning.

3. Requires a proper operating environment

This product is designed for indoor use. Do not use this product near water. Do not place this equipment near or over a radiator or any other heat source.

4. Check the power source voltage

The power source voltage should be within the specified range (Product must meet the specifications).

5. Objects and liquid entry

Never push objects of any kind into this product. Never spill any kind of liquid on the product.

PACKAGE CONTENTS

- One (1) ACA-NTEB No Touch Door Release Exit Sensor
- Two (2) Mounting Screws
- One (1) Manual

*For any returns, please include all components listed above with original packaging in **Resalable Condition**. **Absolutely No Returns** will be accepted if any component is missing/damaged.

PARTS & DIMENSIONS

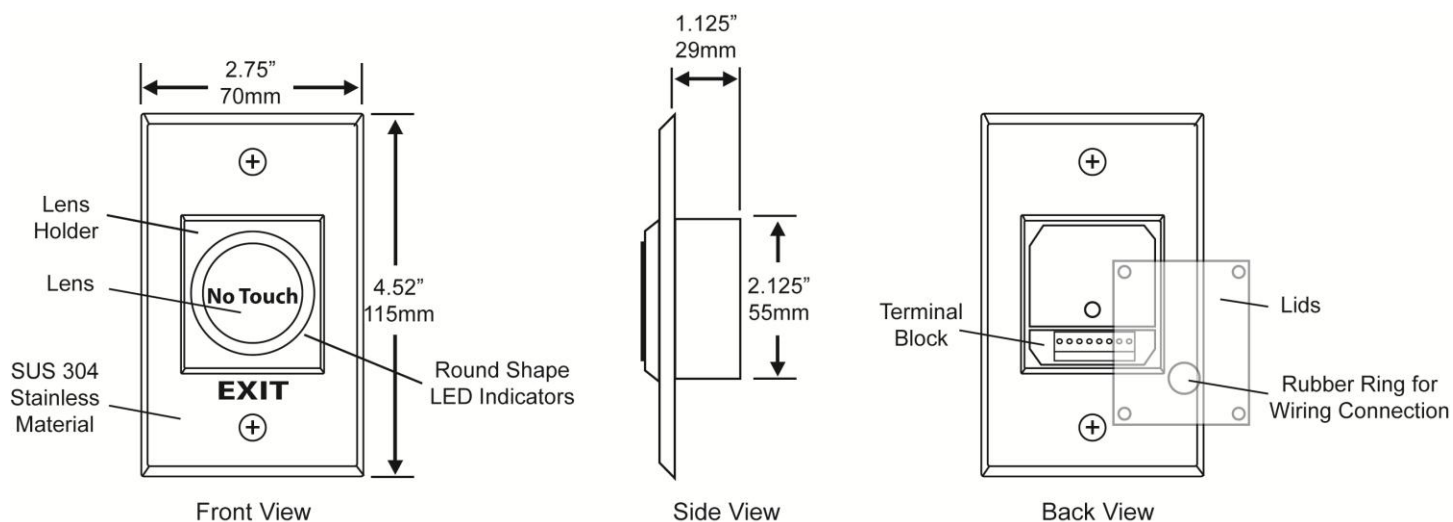

SENSING RANGE & LED

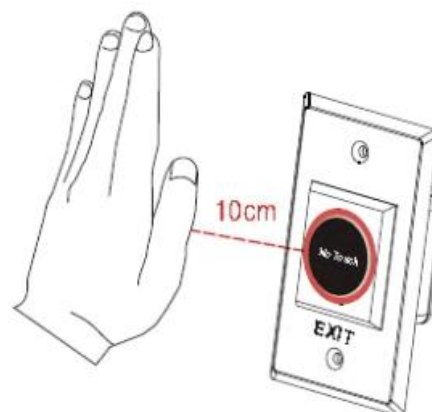
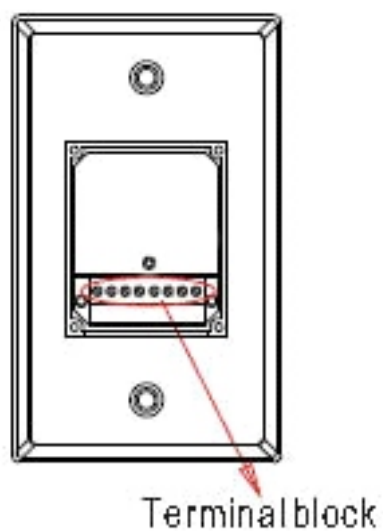

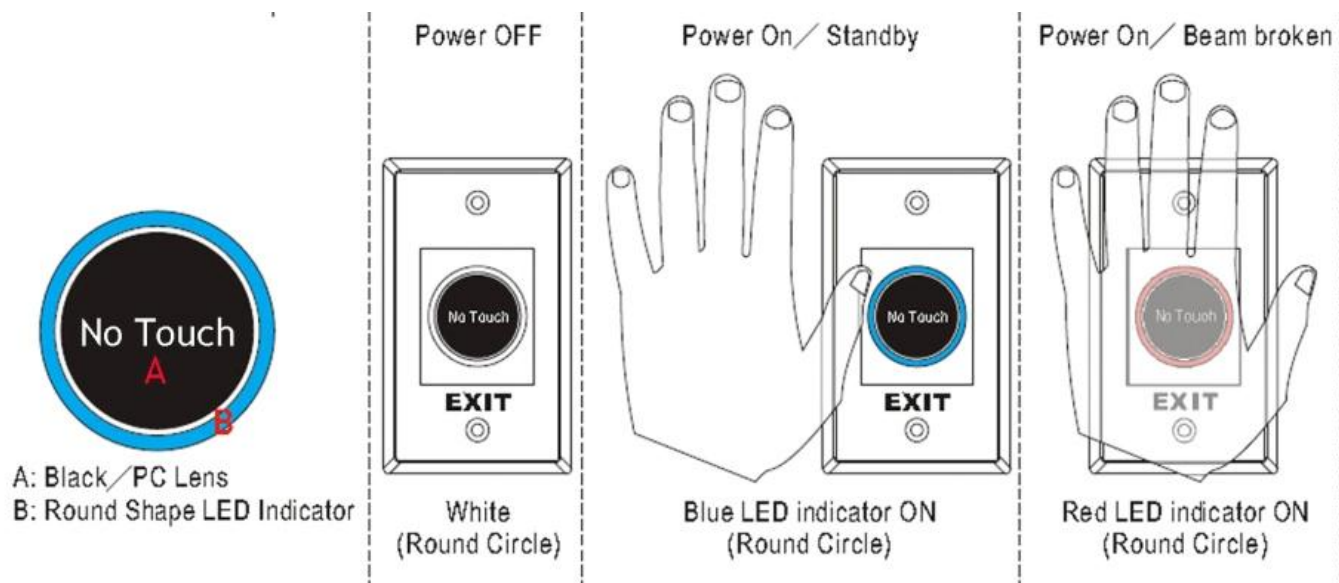

CONNECTION SAMPLE

The cable of the connected with the no touch exit sensor, access control machine and electrical bolt

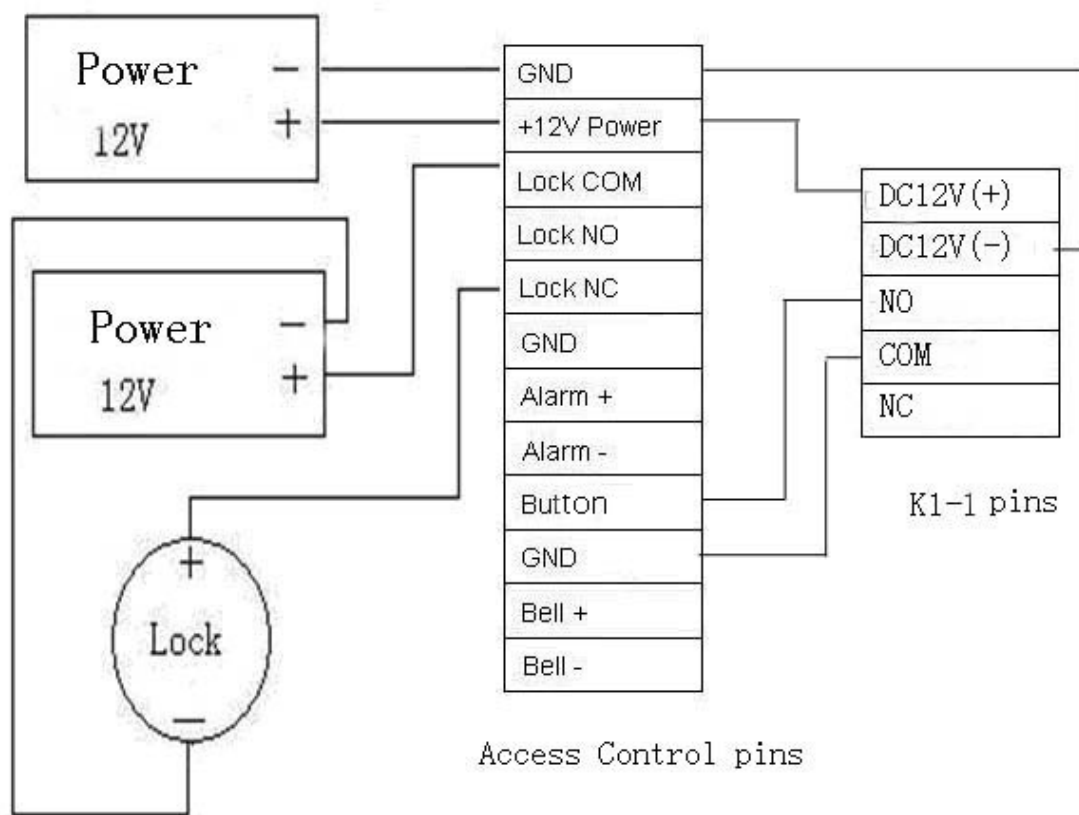

INSTALLATION EXAMPLES

1. Installation with Electromagnetic Lock (Fail-Safe)

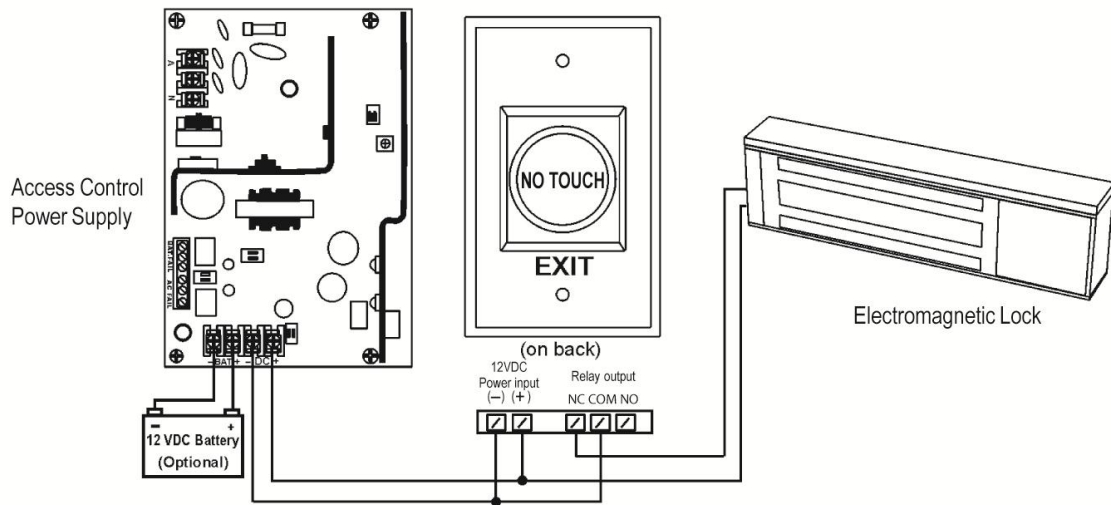

2. Installation with Electric Doorstrike (Fail-Secure)

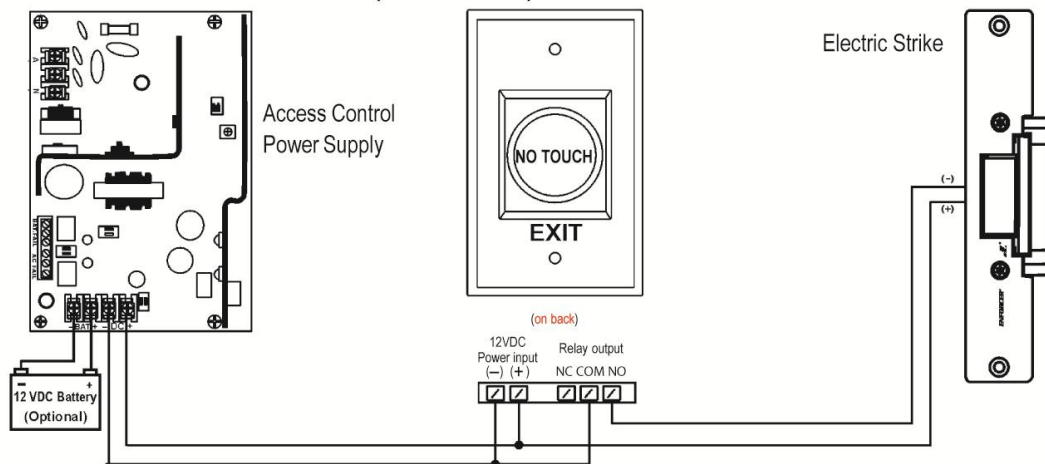

3. Installation with Electromagnetic Lock and Keypad

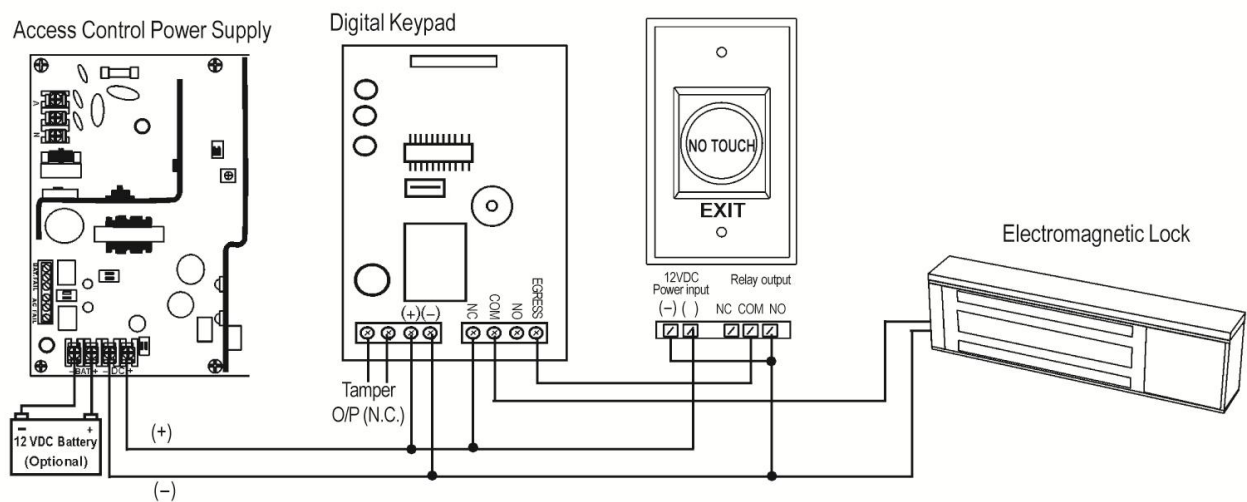

SPECIFICATIONS

Model	ACA-NTEB
Contact Rating	3A/120V AC, 30V DC
Input Volt	12V DC
Life	500,000 times
Detection Range	0.1 ~ 10cm
IP Rating	IP55
Material	SUS 304 stainless steel plate
Operation Temperature	-4°F ~ 131°F / -20°C ~ 55°C
Dimension	4.53" x 2.75" x 1.14" / 115 x 70 x 29mm
Weight	0.19 lbs / 85g

*Specifications are subject to change without notice



Additional Technology Security Inc.
dba: Sentry US

5500 Stewart Avenue
Fremont, CA 94538
E-mail: info@SentryUS.com
Tel: 1-800-916-8783
International: 510-279-9992

ZRFID is an affiliate of Sentry US
Specialized in Access Control Products